

# SIBUWORLD

BE PART OF IT.







SIBU | DESIGN  
we decorate.



## ABOUT SIBU DESIGN

1984 Foundation of the SIRO-BURG DESIGN company | 2001 Company renamed as **SIBU DESIGN** | 56 employees | Area: 6,300m<sup>2</sup> (offices / production / warehouse) 2,300m<sup>2</sup> high bay warehouse (therefore short delivery times even for small orders) | SIBU DESIGN GmbH & Co KG is the leading producer of high-quality, design sheets for interiors. The sheets are developed specially for interior design, furniture manufacture, hospitality and shop concepts, as well as fashion, architectural and display purposes.

As a result of its over 35 years of branch experience, SIBU DESIGN has established itself as the market leader. The company's product portfolio includes a stock range of

over 300 designs. SIBU DESIGN stands out owing to its fashionable designs, top quality workmanship, short delivery times and its offer of great flexibility with regard to just-in-time projects.

SIBU DESIGN can count among its customers leading surfacing producers in the global market, furniture manufacturers and international textile brands, for which it provides individual designs for store layouts.

Sustainability is constantly SIBU DESIGN main priority. It produces exclusively in Austria and thereby guarantees entirely PVC-free surfaces.





# PRODUCTGROUPS

LEATHER-LINE (LL)

DECO-LINE (DM)

MULTISTYLE (MS)

ACRYLIC-LINE (AC)

STRUCTURE-LINE (SL)

PUNCH-LINE/3D (PL/PL3D)

SIBUGLAS (SG)

TRANSLUCENT-LINE (TL)

WOOD-LINE (WL)

SIBU | ANTIGRAV

SIBU | BATH ART

SIBU | BOARD COLLECTION



# PRODUCTSTRUCTURE

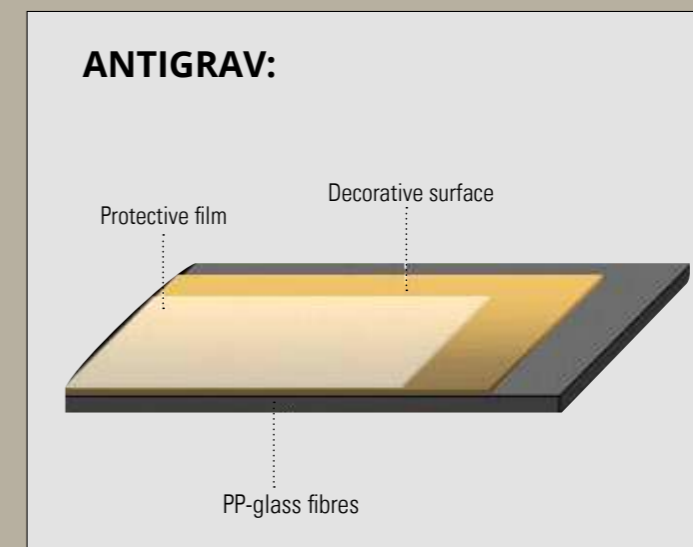
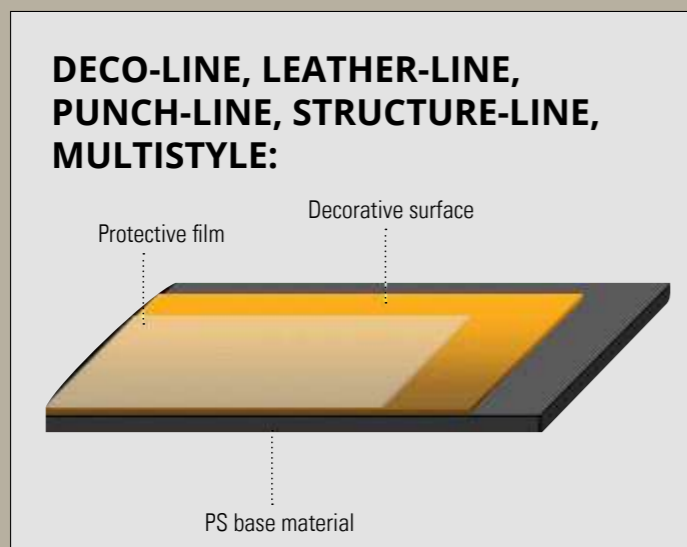

# DIMENSIONS

Standard stock programme: Dimensions: 2,600 x 1,000mm



- › Format production
- › Cut-to-size products, e.g. mirror curtains



# PROCESSING POSSIBILITIES

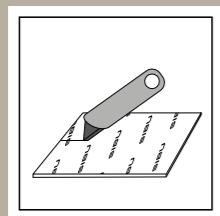

Cutting

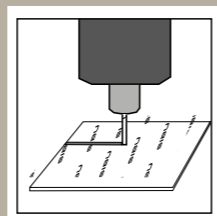

Milling

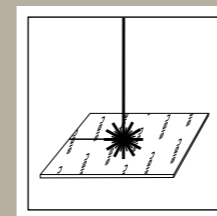

Laser cutting

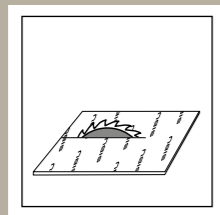

Sawing

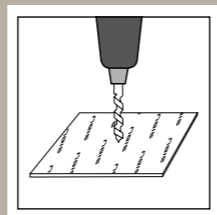

Drilling

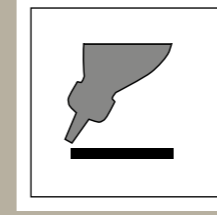

Press bonding

PVA pretreatment

More detailed information you will find in our OVERVIEW and on [www.sibu.at/en/processing](http://www.sibu.at/en/processing)  
Download under: <http://www.sibu.at/en/processing.html>





# PROCESSING INFORMATION

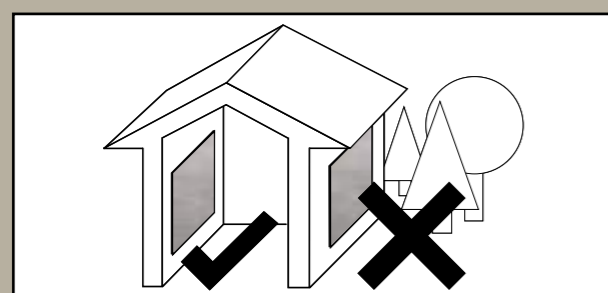

Only for interior application

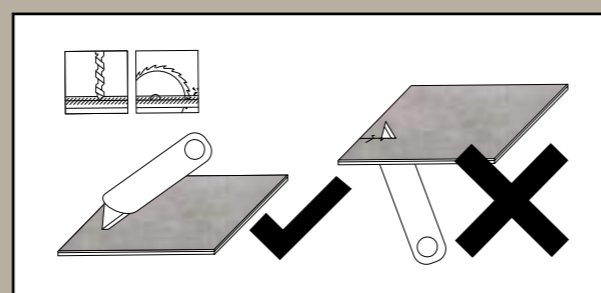

Processing of the design panel always from the top side

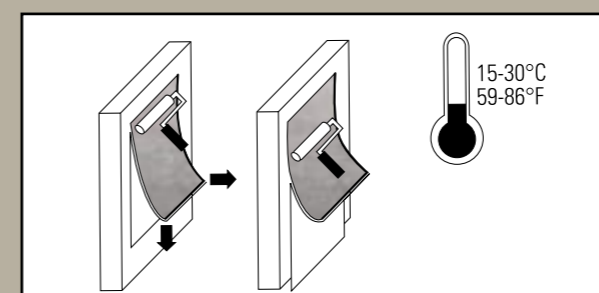

The design sheets should be acclimatized

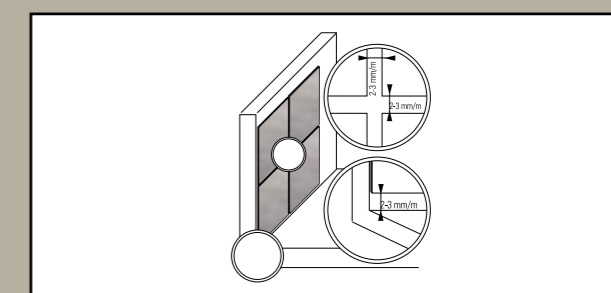

As a rule, an approx. 2-3 mm expansion joint is to be left along the sheet edges!

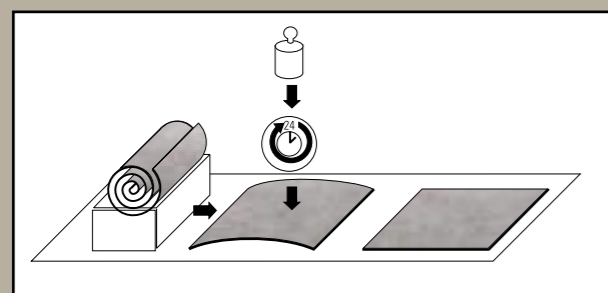

Patterned sheets delivered in rolled form should be kept flat for a minimum of 24 hours. Weighting down improves evenness.

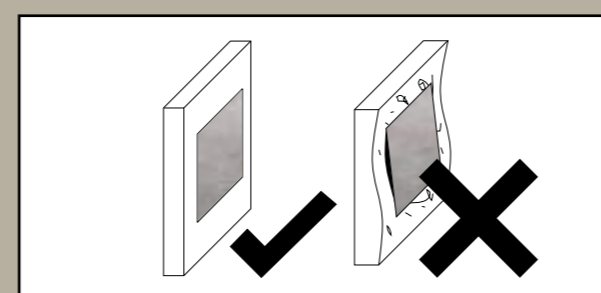

The ground should be dry and flat, free from loose parts, dust, dirt, grease, wax and silicone.

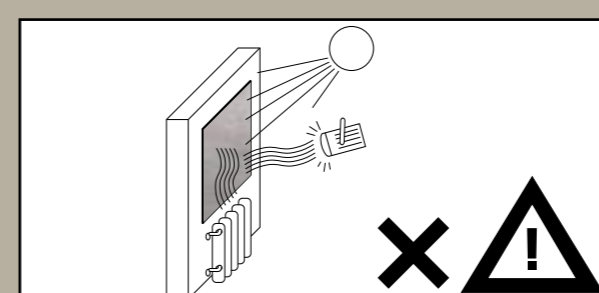

Not recommended for use near open fires or strong heat sources.

You will find detailed information of our processing instructions under: [www.sibu.at](http://www.sibu.at)

# LEATHER-LINE

Our unique synthetic leather surfaces outshine other products.

LEATHER-LINE offers a diversity of designs and top surfaces in highly fashionable colours and all in PVC-free quality.

The range includes versions in stylishly smooth leather, fur, reptilian and decorative grain looks, as well as leather surfaces in shimmering metallic colours.

- › Synthetic leather top surfaces
- › Modish designs and colours
- › High quality haptics
- › Smooth and structured decor
- › 100% PVC-free
- › Suitable for bonding with PVA
- › Also available in magnetic versions



LL LEGUAN Silk



LL PELO Marabu













□ LL PEARL RAY Gold



□ LL LEGUAN Silver



□ LL CORD Charcoal Light



# DECO-LINE

The DECO-LINE delivery programme includes brilliant mirror and metallic top surfaces, as well as modish metal and wood structures. Irrespective of whether they are used for display, printing, furniture, trade fair or shop fitting purposes, DECO-LINE products represent a non plus ultra.

In addition, DECO-LINE products are also available with abrasion-resistant surfaces.

- › Mirror, metal and wood looks
- › Fashionable designs and colours
- › Problem-free printing
- › Many products supplied in a flame-retardant variation
- › Also available in magnetic versions



□ DM OXIDIZED  
Silver AR

□ DM OXIDIZED  
Titan AR

□ DM OXIDIZED  
Platin AR



□ DM Fashion Red



DM Fashion Red



DM LUXURY Bronze













□ DM Silver



□ DM Silver



□ DM Iceblue AR1

Photo: FORM FACTORY Germany





# MULTISTYLE

The MultiStyle delivery programme contains mirror and metallic top surfaces with a stylish mosaic appearance. MultiStyle products are characterised by their extreme flexibility. They can therefore be used in a highly individual manner and even curved surfaces are no problem.

MultiStyle is a must in the display and decoration area!

- › Flexible mosaic mirrors
- › Fashionable designs & colours
- › Problem-free digital printing
- › An absolute eye-catcher
- › Ideal for rounded surfaces
- › Available in magnetic versions
- › Standard format: 980x980mm, can also be supplied in a 2,600 x 1,000mm format!



□ MS 5x5 flex Classic GALAXYSilver

Photo: Spacetekusa



□ MS 10x10 flex Classic Silver

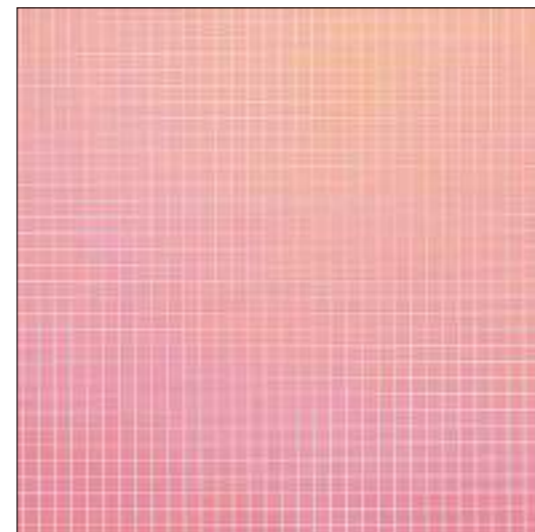

MS 5x5 flex Classic Hollywood



MS 10x10 flex Classic Silver





Photo: Malo Clinic at El Corte Ingles - Lisboa



# ACRYLIC-LINE

The SIBU ACRYLIC-LINE incorporates structured, high gloss surfaces in top quality ABS/PMMA material and turns furniture into a genuine eye-catcher. In addition, the homogenous acrylic material not only stands out due to its shining appearance, but also its excellent processing characteristics and abrasion resistance.

Moreover, should the robust top surface be damaged at any time, it can be easily re-burnished.

- › High-gloss appearance
- › Structured ABS/PMMA
- › Extremely abrasion-resistant
- › Suitable for bonding with PVA
- › Ideal for furniture fronts
- › Also available in a 2,690 x 1,220mm format



AC MOTION ONE White

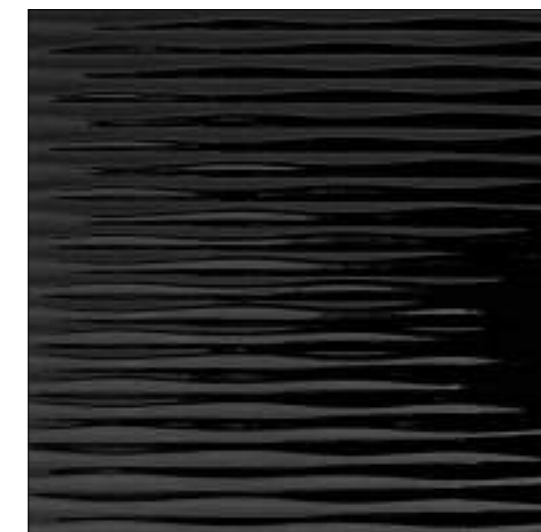

AC MOTION TWO Black

□ AC MOTION ONE Black

□ AC MOTION ONE Black





Photo: GARANTküche



# STRUCTURE- LINE

SIBU STRUCTURE-LINE is perfect for those looking for a structured scene-stealer.

Three-dimensionality combined with fashionable colour combinations lends the STRUCTURE-LINE range an unmistakable appearance.

And irrespective of whether a concrete, vintage, reptilian, metallic or wood surface look is wanted, the perfect product is available for every taste.

- › Designs with a structure
- › Vintage look
- › Reptilian look
- › Metallic look
- › Can be supplied in magnetic versions



□ SL CRASHED OLD Platin



SL CRASHED OLD Platin



SL LAVA VINTAGE Copper







# PUNCH-LINE

## PUNCH-LINE/3D

The SIBU PUNCH-LINE/3D range includes perforated, metallic surfaces in abrasion-resistant quality.

Stylish, 3D effect films lend the PUNCH-LINE 3D perforated patterns their name and the series again offers top looks and fashionable colours.

- › Perforated pattern sheets
- › Available with 3D effects
- › Metallic appearance
- › Abrasion-resistant variations
- › Available in magnetic versions

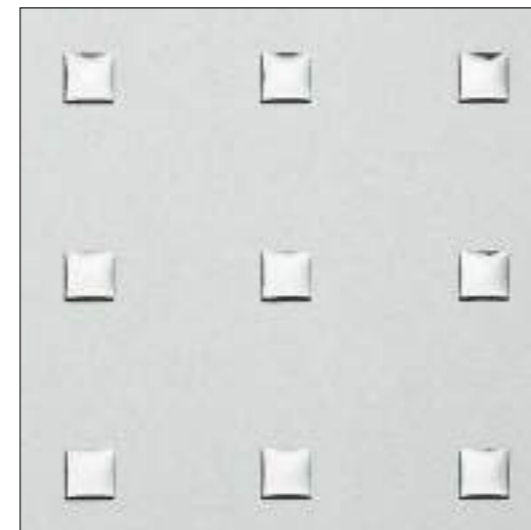
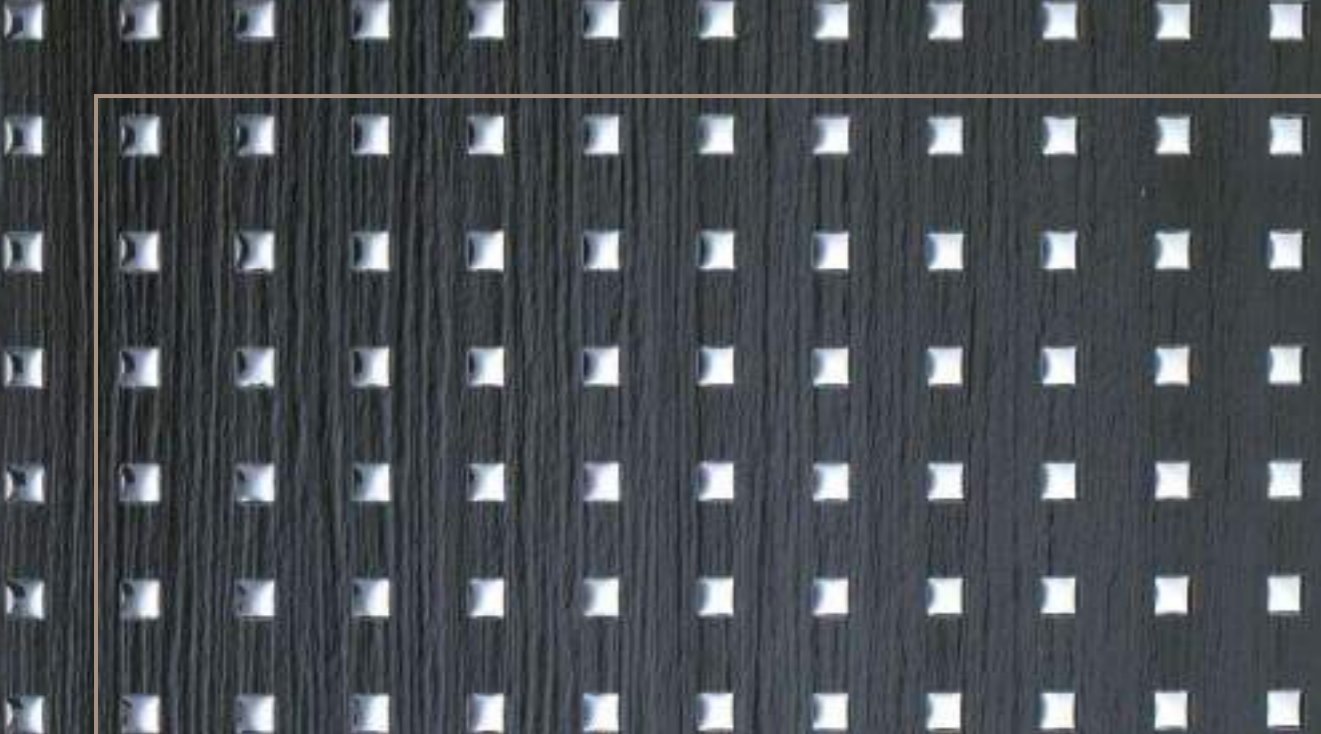

PL3D Q 10-40-40 Silver PF/Silver



PL3D Q-10-30 OLD Platin/Silver







# SIBUGLAS

Acrylic glass backed by leather and co. creates a revolutionary depth effect that transforms items of furniture into unique design objects.

SIBUGLAS products are extremely abrasion-resistant (AR+).

- › Acrylic glass
- › High-gloss surfaces
- › Extreme depth effect
- › Abrasion-resistant
- › Available in magnetic versions

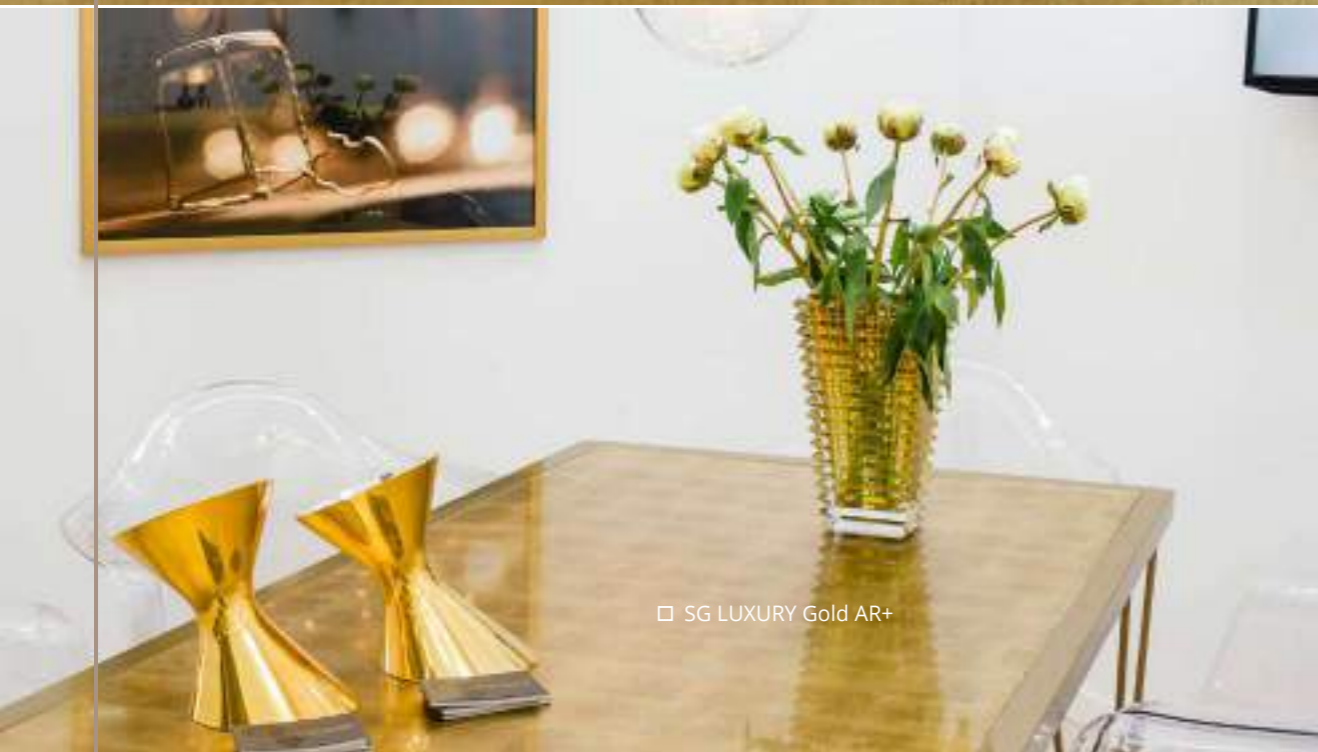

SG GRID Rose AR+

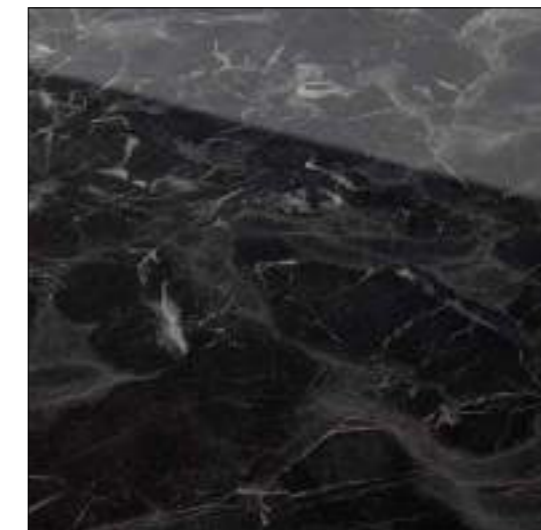

SG MARBLE Black AR+













□ SG LUXURY Gold AR+



□ SG MARBLE Brown AR+



□ SG GENESIS Grey AR+



# SIBUGLAS PROCESSING

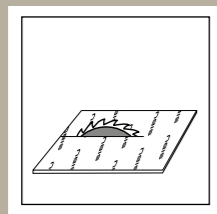

Sawing

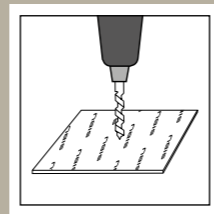

Drilling

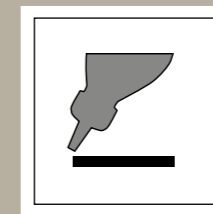

Press bonding

PVA pretreatment

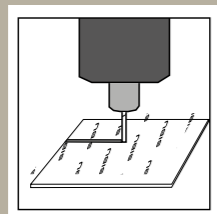

Milling

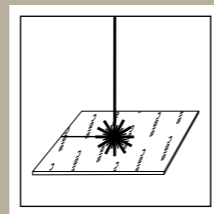

Laser cutting

- › Working with self-adhesive SIBUGLAS
- › press bonding SIBUGLAS



# SIBUGLAS self-adhesive on wood base sheets

- › Remove the adhesive cover and bond the sheet onto the wood base sheet (rubber roller). No counter-pressure required.
- › Cut to the required dimensions and apply the edging.
- › Using an electrical manual router, mill a rounded edge exactly up to the point of transition from the transparent PMMA layer to the structured layer.

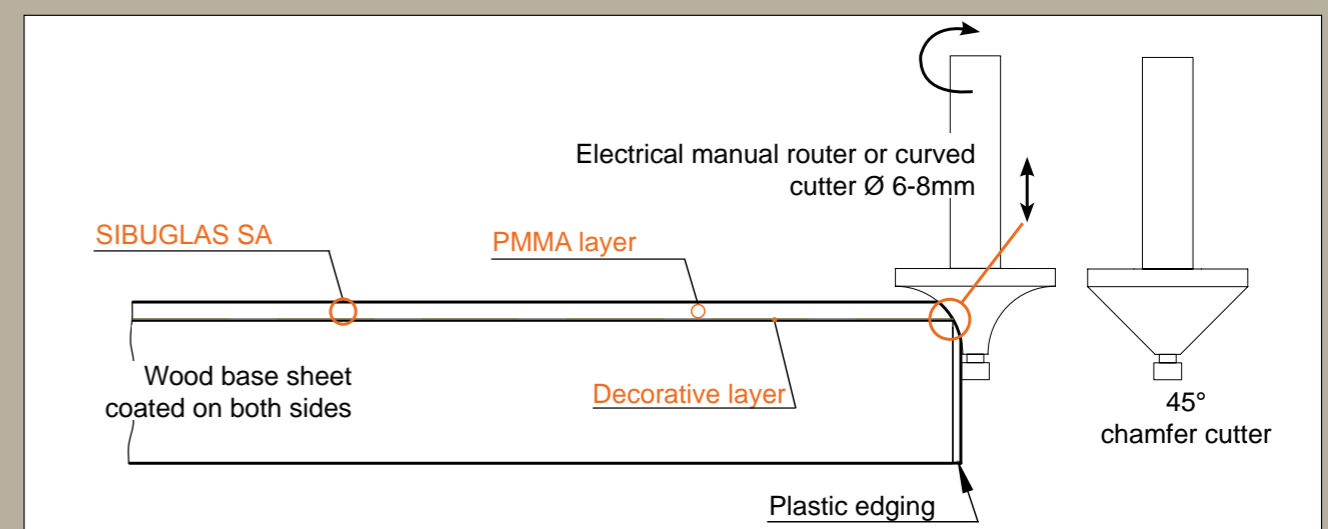



# TRANSLUCENT-LINE

Our latest product series, TRANSLUCENT-LINE brightens up any surroundings! The recesses in the sheet allow light through and therefore are ideal for backlighting.

Whether for ceilings, bar or wall panelling, the TRANSLUCENT-LINE lends every room touches of brilliance.

Lighting: LED, fluorescent tubes

## INDIVIDUAL LIGHT MOTIFS POSSIBLE

Any logotype, form or design can be completed problem-free.

Simply send us a technical drawing in dxf or dwg format.



TL LINEA 104x62 SILENT Gold



TL LINEA 104x62 OLD Platin

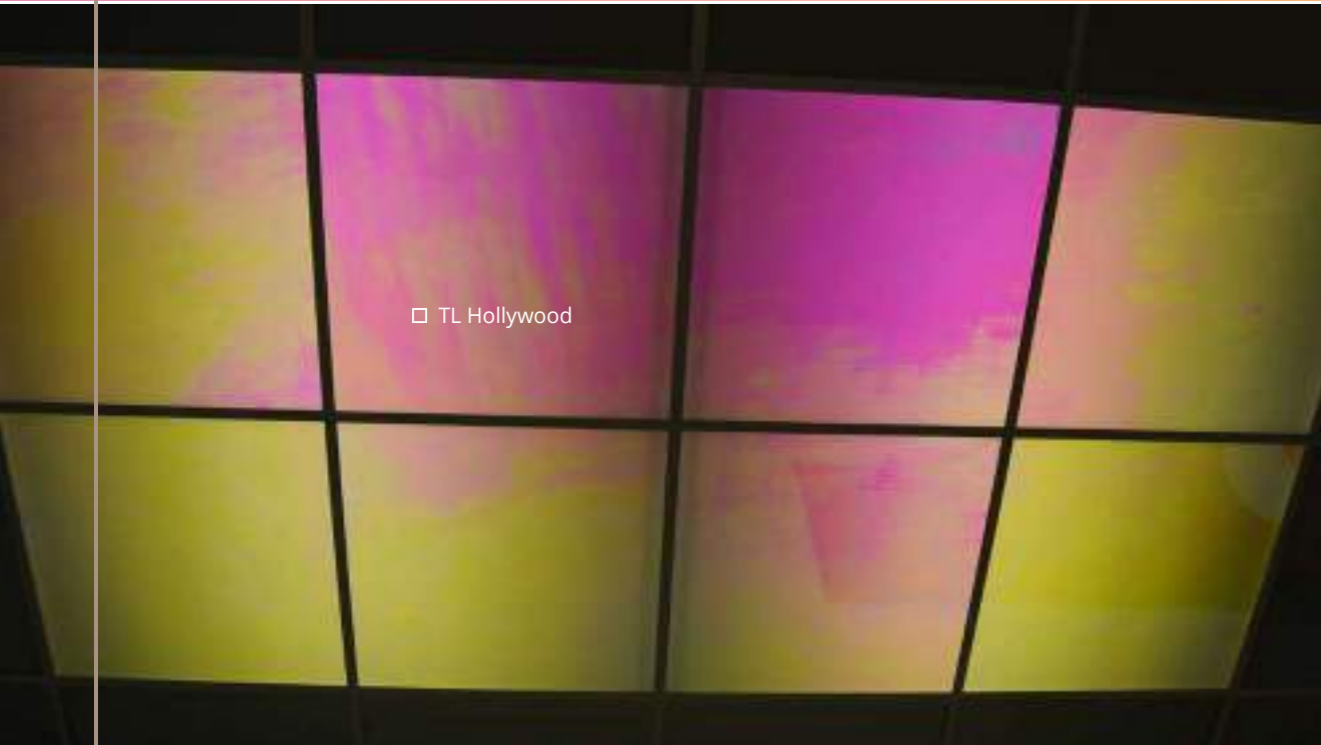









□ WL Maple Alpine



□ WL Wenge Wood

# WOOD-LINE

SIBU DESIGN goes nature - and its new WOOD-LINE product range offers fashionable shades with an animate grain structure. WOOD-LINE brings a breath of the forest into every home.

Whether used partly or extensively, the wood patterns from SIBU DESIGN lend the perfect finishing touch to your furniture.

So lend new life to your furnishings with WOOD-LINE's natural haptics.

Suitable edges are available for all WOOD-LINE products.



WL Nutwood



WL Carbonized Wood













□ WL Nutwood



□ WL Maple Alpine ANTIGRAV



□ WL Nutwood Country



# SIBU | ANTIGRAV

## JOINT-FREE PROCESSING

SIBU | ANTIGRAV is an innovative, lightweight material that comes from the automotive industry and which, in combination with decorative SIBU Design surfaces, can be used as wall panelling.

Moreover, processing is **joint-free** and SIBU | ANTIGRAV is extremely light and compact, which means that it can be cut and further processed using standard tools.

Readjustment **on any surface** is no problem when bonding with standard silicon or hybrid polymer adhesive is employed.

SIBU | ANTIGRAV products are available in a flame retardant version (FR). (ASTM)

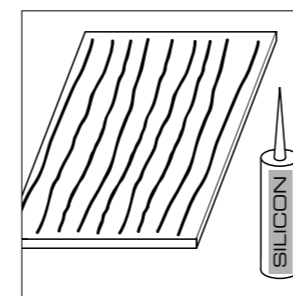

Apply beads of silicone vertically (1cm from the edge and with 6cm-spaces between the individual beads).

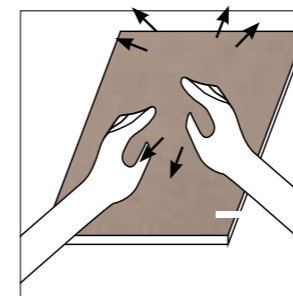

Press the sheet onto the wall and then adjust it.

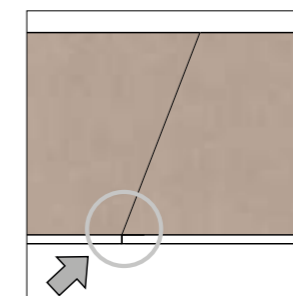

Bonding is edge to edge = 0mm expansion joint



LL Charcoal Dark ANTIGRAV



LL LEGUAN Silver ANTIGRAV





Photo: Fotolia.com





# SIBU | BATH ART

## THE BEGINNING OF A NEW ERA!

Because as of now you can also savour sophisticated surface patterns from the creative pioneer SIBU DESIGN throughout your bathroom!

The astonishing depth effect and high gloss surfaces of the SIBU | BATH ART Collection are certain to amaze and will bring your dream bathroom a step nearer. Immerse yourself in our product worlds and the enchantment of their unique designs.

Irrespective of whether for a renovation or a new project, SIBU | BATH ART products provide a time saving and innovative solution for your very personal bathroom design.



□ BA MARBLE Black AR+



BA GENESIS Grey AR+

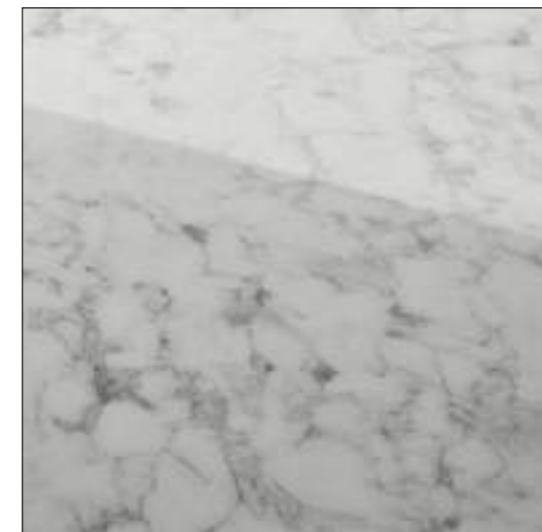

BA MARBLE White AR+





□ BA GENESIS Grey AR+



# SIBU | BOARD

## c o l l e c t i o n

Design meets function - in the SIBU | BOARD COLLECTION, which for the first time makes fashionable SIBU DESIGN patterns available on ready-pressed MDF boards. Accordingly, the SIBU | BOARD COLLECTION, which has been created in response to major demand, offers a simple but nonetheless innovative solution for the daily needs of the furniture industry.

- › Vintage-, Used- and stone patterned sheets with abrasion-resistant surfaces
- › Pattern pressed onto MDF with suitable balancing material
- › 2800 x 1250mm delivery dimension
- › Straightforward, problem-free processing on edged furniture fronts
- › Suitable edges are available for all SIBU | BOARD COLLECTION products.



DM BOARD SLIGHTLY USED Titan AR



SG BOARD LUXURY Bronze AR+







# HOSPITALITY









# SLIDING DOORS







Photo: Boris Breuer - CABINET Schranksysteme AG



# EXHIBITIONDESIGN









# FURNITURE | KITCHEN









# WALLDECORATION









# STORECONSTRUCTION

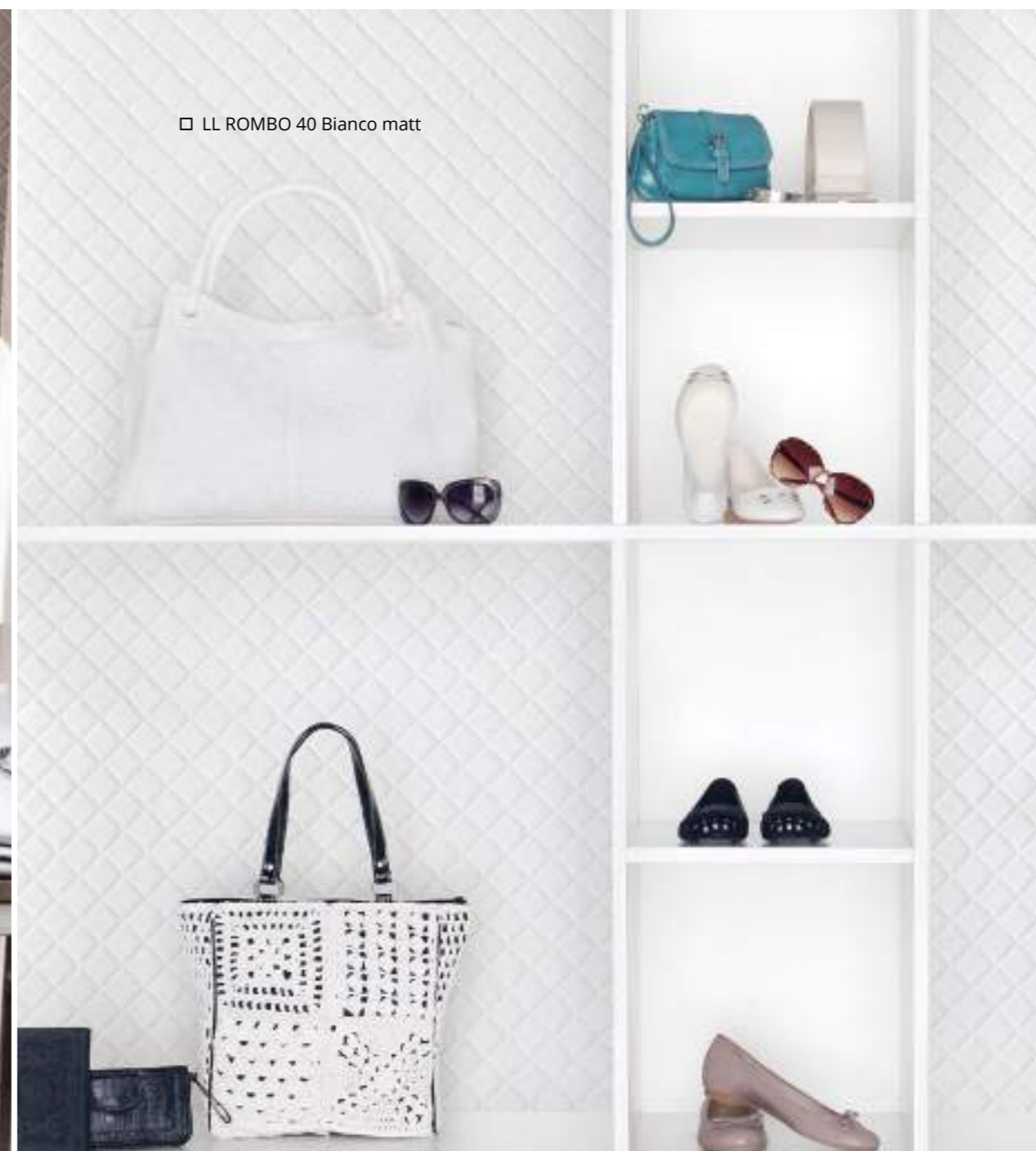







# SHOPWINDOW | DISPLAY



□ MS 5x5 flex Classic Silver (printed)



□ DM Iceblue AR



□ MS 5x5 flex Classic Silver









# ADVERTISING MATERIAL

The range of SIBU DESIGN sales documentation at a glance.



## **Overview Version 7**

Complete catalogue (PDF Version only)

## **SIBU World 2020**

Overall presentation

## **Produktkataloge** (with original samples)

- » About SIBU DESIGN
- » SIBUGLAS
- » DECO-LINE DISPLAY
- » DECO-LINE DECORATION
- » LEATHER-LINE
- » WOOD-LINE
- » MULTISTYLE / PUNCH-LINE / PUNCH-LINE 3D
- » STRUCTURE-LINE / ACRYLIC-LINE / TRANSLUCENT-LINE
- » ANTIGRAV
- » BOARD COLLECTION
- » BATH ART



# Immerse yourself in the world of SIBU DESIGN.

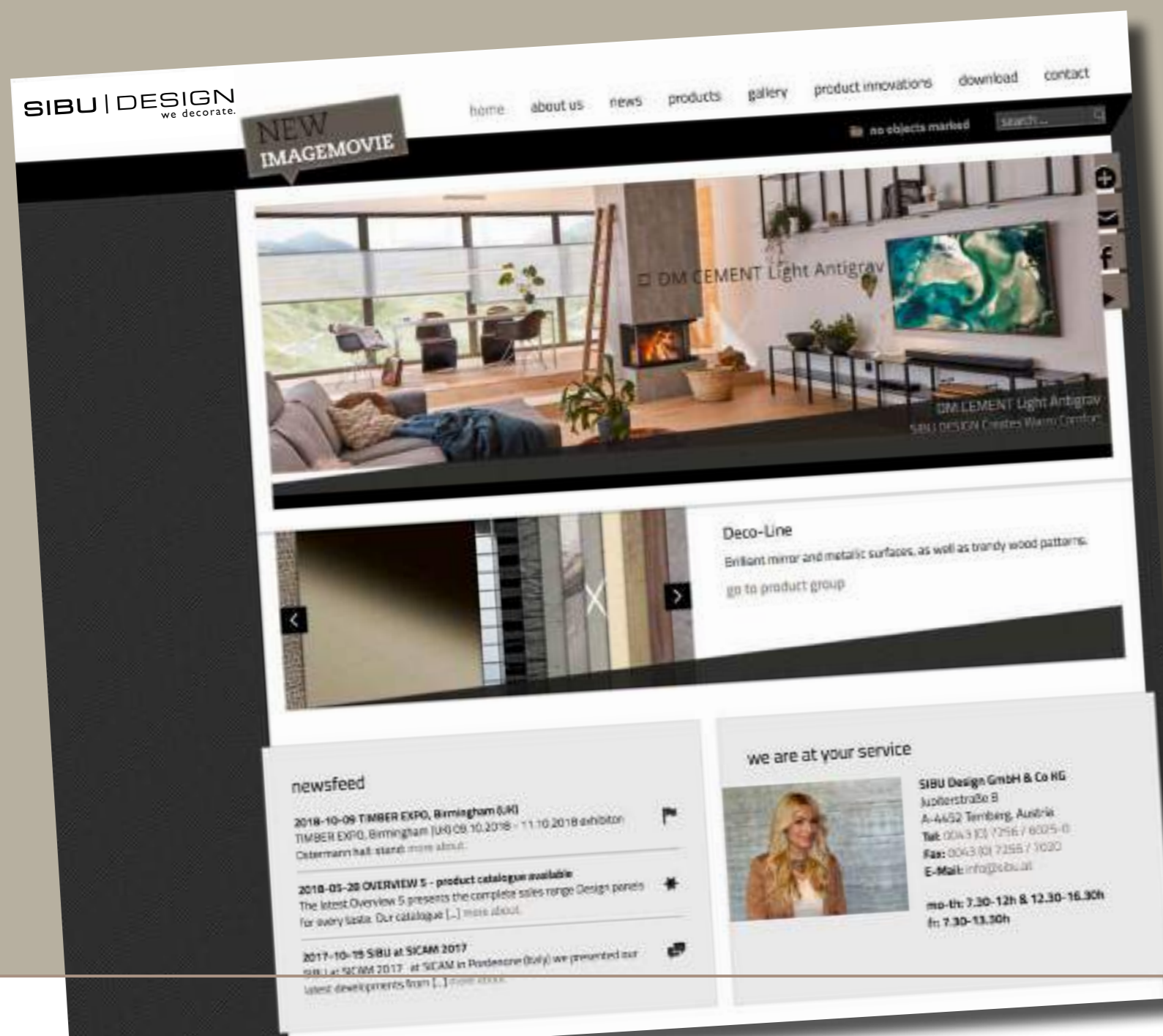

Detailed information regarding  
our products can be found in  
our OVERVIEW catalogues  
or on our website at  
[www.sibu.at](http://www.sibu.at).



# SIBU | DESIGN

we decorate.

SIBU DESIGN GmbH & CoKG  
Jupiterstraße 8 - 4452 Ternberg - Austria - Tel.: +43 (0) 7256.6025.0  
Fax: +43 (0) 7256.7020 - [info@sibu.at](mailto:info@sibu.at) - [www.sibu.at](http://www.sibu.at)

